

# NP-1600MD Medical DICOM Printer

## Product Description

### Overview

The NP-1600MD Medical DICOM Printer is an intelligent, dye diffusion, color and grayscale output device which provides both 10Mb/s and 100Mb/s Ethernet and Centronics compatible parallel interfaces. In addition to DICOM, the printer accepts many industry standard file formats and includes built-in image processing and spooling capabilities.

### Specifications

Print Technology:	Dye diffusion.
Resolution:	300 dpi (11.8 pixels/mm).
Color Output:	16.7 million colors 256 levels each of cyan, magenta, and yellow (optional laminate overcoat).
Grayscale Output:	256 levels, black ribbon with laminate overcoat support.
Density:	Min. 0.05 (Refl), 0.04 (Trans). Max. 2.30 (Refl), 1.70 (Trans).
Interfaces:	Ethernet: AUI 15-pin connector. Parallel: Centronics type 36-pin connector. Optional: M-O Drive, 3.5 inch.
Network Protocols:	FTP, LPR, Telnet (TCP/IP), EtherTalk.
Image Formats:	Standard: TIFF, GIF, PCX, BMP, PBM, PGM, PPM, XWD, JPEG, Sun Raster, SGI RGB, Targa, and DICOM 3.0. Optional: DEFF, PostScript.
Image Scaling:	Box, Bilinear, Bicubic, Mitchell, and Lanczos, software selectable.
Image Rotation:	90 degrees, software selectable.
Image Correction:	Gamma, contrast, antialiasing (PostScript), TCR, Medical Color Matching, selectable from front panel or via software.
Image Formatting:	Variable Multifformatting (VMF), Fixed Multifformatting (FMF), 35mm SlideMaker, Captions, and Bracketing
Front Panel:	16-character LCD, Power, and Fault indicators, Online and Cancel buttons.
Memory:	96MB (16MB RAM, 80MB virtual).
Disk:	1.2 GB (950MB available for spooling).
Floppy Drive:	Built-in for software upgrades.
Cassettes:	One adjustable cassette included with printer. 100 sheet capacity, paper or transparency. Single sheet bypass feed.
Power:	Autosensing, 90-264 VAC, 47-63 Hz, 250 Watts.
Weight:	60 lbs.
Dimensions:	12" H, 17" W, 21" L.

### Printer and Cassette



### Back Panel

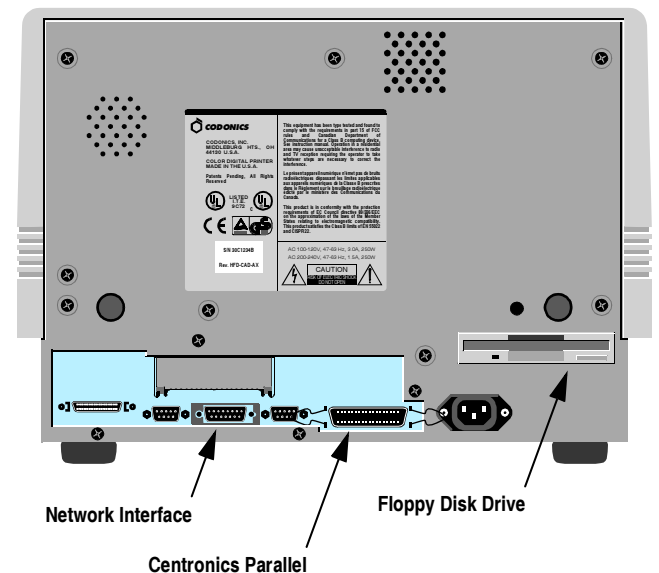

Get it all with just one call  
1-800-444-1198