

# Codonics Infinity Expansion Module Chassis Replacement

**Technical Brief**

## Overview

The Codonics Infinity® Expansion Module supports customer replacement of the expansion module chassis. This document describes the procedure for installing the replacement chassis.

**CAUTION:** The user should be properly grounded and observe anti-static procedures when replacing the expansion module chassis.

## Prepare the Replacement Chassis

The new chassis will not include hard drives or power supply modules. These components must be moved from the failed chassis to the new chassis.

1. Unpack the Infinity Expansion Module replacement chassis.
2. Place the replacement chassis on a flat, solid surface near the original chassis.
3. Remove the tape securing the front cover.

The interior of the replacement chassis has four empty hard drive slots. The hard drives and the AC power adapter will be transferred from the failed chassis.

## Shut Down the Infinity System

1. Shut down the Infinity system. Refer to “Shutting Down and Rebooting” in the Infinity User’s Manual.
2. If there is a UPS, power it off.
3. Disconnect the AC power cord from the power outlet or UPS.

## Transfer Hard Drives

1. Open the front door of the failed chassis.
2. For each hard drive in the old chassis:
  - a. Open the hard drive’s lever by pulling up on the blue tab to open the lever to about 45°.

This disconnects the hard drive from the internal connector.

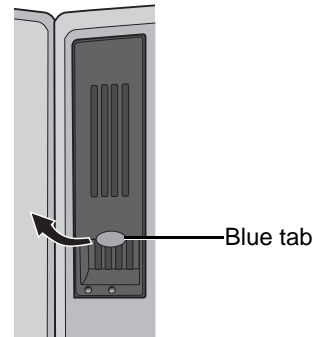

- b. Slide the hard drive out of the old chassis.

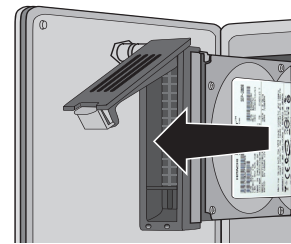

**CAUTION:** Use care when handling hard drives. Do not drop the hard drive. Handle only the front, side edges, and face with the label. Do not handle the underside or the backplane of the drive. Do not touch any exposed electronics.

- c. Slide the hard drive fully into the corresponding slot in the replacement chassis.

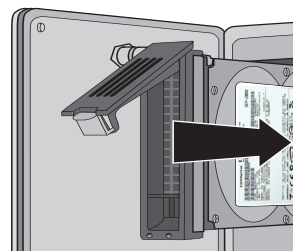

**CAUTION:** When installing the hard drive, it is important to insert it all the way into its slot. Push the drive as far into the slot as it will go (it should be flush with the neighboring drives). There is some resistance when the back of the drive is seated in the cage. It is possible to latch the lever without having the drive fully installed. It is critical that all drives are properly installed prior to the initial system startup of the replacement chassis.

**CAUTION:** Make sure that each hard drive is installed in the corresponding slot in the replacement chassis.

- d. Close the hard drive lever to lock the drive in place. The lever will click into position when it is fully closed and locked.

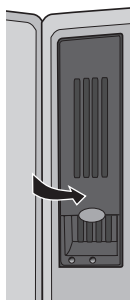

### Connect Power Adapter and SAS Cables

1. Release the retaining clip and disconnect the power adapter's connector from the power plug on the rear of the failed chassis.

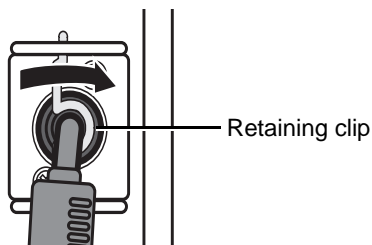

2. Connect the power cord to the power connector on the rear of the replacement chassis.
3. Secure the power cord with the retaining clip.

4. Disconnect the SAS cable(s) from the rear of the failed chassis and connect them to the corresponding IN and OUT connectors of the replacement chassis.

The first figure below shows the SAS cable connection (the gray cable) from the main chassis' SAS connector to the first expansion module's SAS IN connector. The second figure below shows the SAS cable connections between the SAS OUT connector of an expansion module to the SAS IN connector of the next expansion module in the chain.

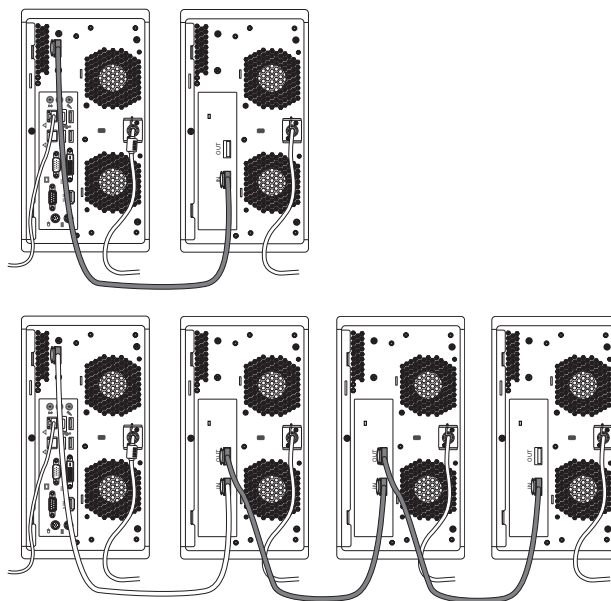

### Power On and Start Up the System

1. Plug the AC power cord into the power outlet or UPS.
2. Momentarily press the Power button at the front of the Infinity main chassis to start up the system.

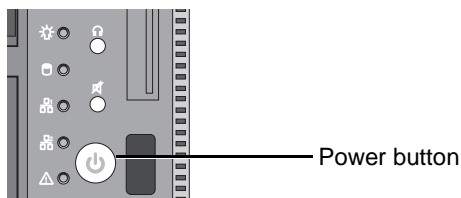

### Technical Support

If problems occur during the chassis replacement, contact Codonics Technical Support between the hours of 8:30AM and 5:30PM EST (weekends and U.S. holidays excluded).

Phone: 440-243-1198  
 E-mail: support@codonics.com  
 Website: www.codonics.com

*Get it all with just one call*  
**1-800-444-1198**

All registered and unregistered trademarks are the property of their respective owners. Specifications subject to change without notice. Patents pending.

Copyright © 2010 Codonics, Inc. Printed in the U.S.A. Part No. 901-400-001.01.



17991 Englewood Drive  
 Middleburg Heights, OH 44130 USA  
 (440) 243-1198  
 (440) 243-1334 Fax  
 info@codonics.com  
 www.codonics.com

Codonics Limited KK  
 New Shibaura Bldg. F1  
 1-3-11, Shibaura  
 Minato-ku, Tokyo, 105-0023 JAPAN  
 81-3-5730-2297  
 81-3-5730-2295 Fax